

# CURRENT TRANSFORMERS

Model 76

Window Diameter 3.00"

APPLICATION:  
With ammeters, wattmeters, and cross current compensation.

FREQUENCY:  
50-400 Hz.

INSULATION LEVEL:  
600 Volts, 10 kV BIL full wave.

- Flexible leads are UL 1015 105 ° C, CSA approved, #16 AWG, 24" long.
- Non-standard length to be specified.
- Terminals are brass studs No. 8-32 UNC with one flat washer, lockwasher and regular nut.
- SFT case styles also available as SFL with leads.
- Approximate weight: 0.9 lb.

**AL** E93779 **SR** LR8403

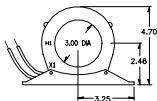
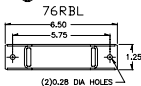
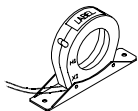
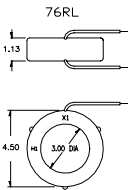
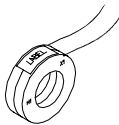
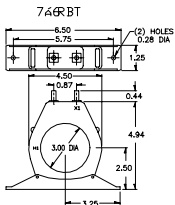
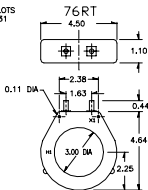
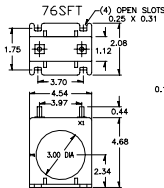
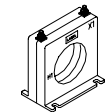

CATALOG NUMBER	CURRENT RATIO	ACCURACY AT 60 Hz	BURDEN VA at 60 Hz
76** - 201	200:5	± 1 %	5.0
76** - 251	250:5	± 1 %	5.0
76** - 301	300:5	± 1 %	6.0
76** - 401	400:5	± 1 %	10.0
76** - 501	500:5	± 1 %	10.0
76** - 601	600:5	± 1 %	10.0
76** - 751	750:5	± 1 %	10.0
76** - 801	800:5	± 1 %	12.5
76** - 102	1000:5	± 1 %	10.0
76** - 122	1200:5	± 1 %	10.0
76** - 152	1500:5	± 1 %	12.5
76** - 162	1600:5	± 1 %	12.5
76** - 202	2000:5	± 1 %	15.0

\*\* NOTE: When ordering, prefix Cat No. with model designation required, i.e. 76RL-101, 76RBL-251, etc.